

RCP Relay Control Panels

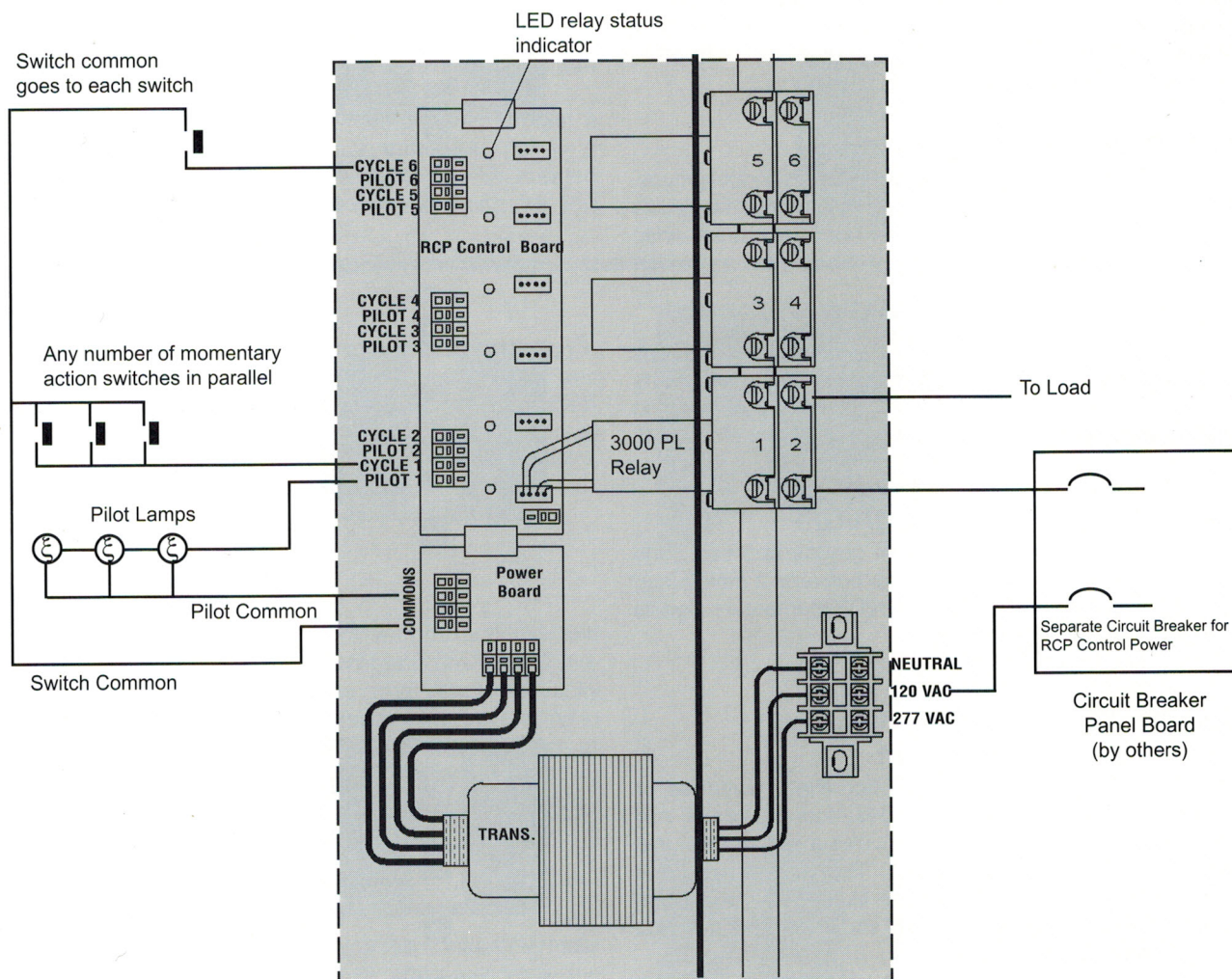

The pre-assembled RCP series of relay control panels are installed where low cost, low voltage remote control is desired, and where control of more than one relay at a time is not required. RCP panels include a pilot light transformer to energize illuminated switches, and a relay status indication on the logic board. RCP panels are U.L. Listed as complete assemblies.

The RCP Series consist of a steel enclosure with a power supply for switching and pilot lights, and 3000-PL relays mounted in a barrier channel and pre-wired to the control circuit board. RCP allows individual relay control only. More than one relay cannot be driven by a single switch. However, multiple switches may be used to control one relay.

Relays are activated by a single momentary switch. Each time the switch is actuated, it changes the state of the relay. The function is similar to the use of the "Power" button of a TV set. This means only two wires (one per switch, plus common) are required to achieve both ON and OFF, instead of 3 or 4

wires per switch. If there are many relays in the system, this can be a substantial savings. In addition to the wire savings, the labor for wiring the switches and the relay panels is reduced.

Stuck Switch Protection

Stuck switch protection is built into the RCP series. If a switch is held closed RCP will block operation of that relay only, and not harm the relay coil or other system components. All other relays will operate.

Panel status Indication

Each relay drive card has an LED indicators to display the On/Off status of each relay. Also the power supply card has two LED indicators to verify both secondary voltages of the transformer and quickly direct trouble shooting should service be required.

Relay Panel

Each RCP Relay Panel contains a transformer with a power supply board, one relay control board for every six (6) relays, and the corresponding relays. All of these components are mounted in the steel enclosure making a U.L. Listed assembly. The enclosure comes with a hinged locking door, or an optional Flush Mount door and trim.

Switch Connections

Switch wires are terminated into color-coded spring-clamp

connectors, (orange for the switch, blue for the LED) and a tool to open and close the connector is provided in the RCP panel. Once the wire is cut and stripped, it is directly inserted into the connector. No spades, lugs, or screwdrivers are required.

LED Switch Status Indication

The internal Power Supply is rated for illuminating up to 220 LED's or 24 Incandescent lamps. Touch-Plate recommends using their LED switch models.

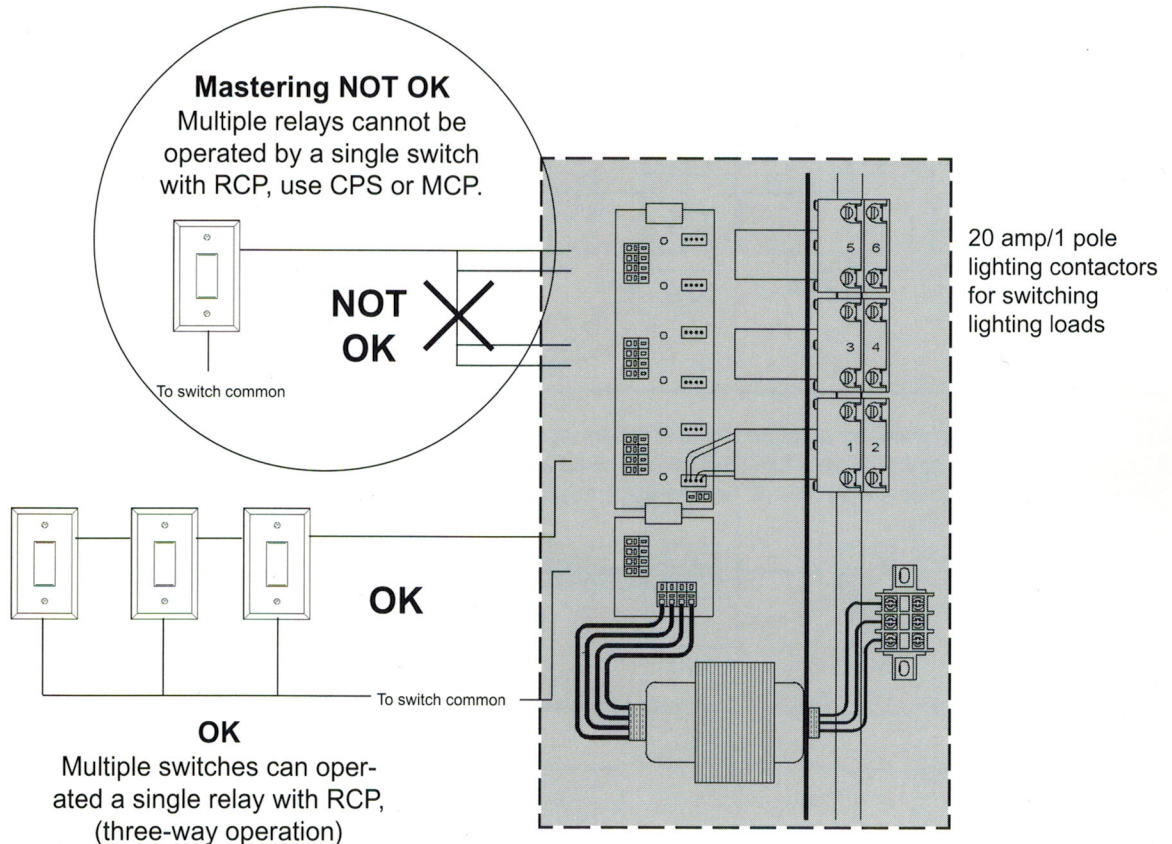

RCP - Part Numbers

Model#	Outputs		Individual Inputs	Dimensions			Approx. Weight
	Relays	Signal		W	L	D	
RCP-0006	6	6	6	12"	14"	4-1/4"	15 lbs.
RCP-0012	12	12	12	18"	14"	4-1/4"	25 lbs.
RCP-0018	18	18	18	18"	32"	4-1/4"	43 lbs.
RCP-0024	24	24	24	18"	32"	4-1/4"	48 lbs.
RCP-0030	30	30	30	24"	40"	4-1/4"	68 lbs.
RCP-0036	36	36	36	24"	48"	4-1/4"	71 lbs.
RCP-0042	42	42	42	24"	48"	4-1/4"	91 lbs.
RCP-0048	48	48	48	20"	59"	5-3/4"	97 lbs.

- Notes:
1. Enclosure come with hinged locking doors.
 2. RCP panels are pre-assembled with 120/277 dual tap power supply.
 3. Relays pre-wired to logic boards.
 3. U.L. Listed for 120 VAC and 277 VAC., CSA Rated to 347 VAC.